

DRAFT 001

Dolomite® Gloss®

**en Rollator
User Manual**

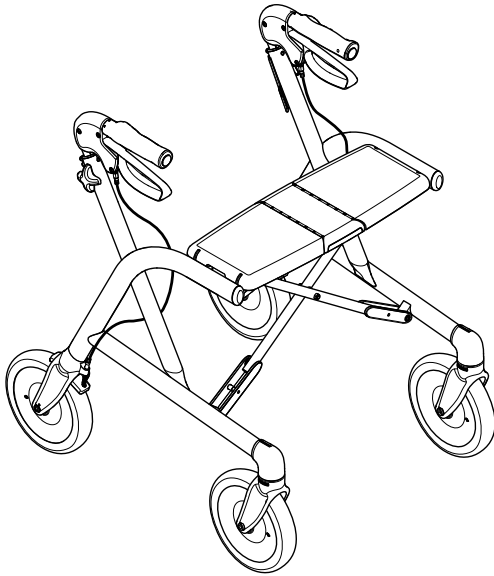

This manual **MUST** be given to the user of the product.
BEFORE using this product, this manual **MUST** be read and saved for
future reference.

Dolomite



Yes, you can.®

©2019 Invacare Corporation

All rights reserved. Reproduction, duplication or modification in whole or in part is prohibited without prior written permission from Invacare. Trademarks are identified by ™ and ®. All trademarks are owned by or licensed to Invacare Corporation or its subsidiaries unless otherwise noted.

Making Life's Experiences Possible is a registered trademark in the U.S.A.

Contents

1 General	4		
1.1 Introduction	4		
1.2 Symbols in this document	4		
1.3 Compliance	4		
1.4 Service Life	5		
1.5 Warranty Information	5		
1.6 Limitation of Liability	5		
2 Safety	6		
2.1 General Safety Information	6		
2.2 Labels and Symbols on the Product	7		
3 Product Overview	9		
3.1 Product Description	9		
3.2 Intended Use	9		
3.3 Indications for Use	9		
3.4 Main Parts	9		
3.5 Accessories	9		
4 Usage	10		
4.1 Before Use	10		
4.2 Adjusting the handle height	10		
4.3 Unfolding to operating position	11		
4.4 Folding for Storage or Transport	11		
4.5 Walking	11		
4.6 Sitting Down on a Chair	12		
4.7 Rising to a Standing Position	12		
4.8 Sitting on the Walking Aid	13		
4.9 Using the Hand Brakes	13		
5 Maintenance	15		
5.1 General Maintenance Information	15		
5.2 Inspection checklist	15		
5.3 Cleaning and Disinfection	15		
		5.3.1 General safety information	15
		5.3.2 Cleaning Intervals	16
		5.3.3 Cleaning Instructions	16
6 After Use	17		
6.1 Disposal	17		
6.2 Reconditioning	17		
7 Technical Data	18		
7.1 Dimensions and Weights	18		
7.2 Material	19		

1 General

1.1 Introduction

This user manual contains important information about the handling of the product. To ensure safety when using the product, read the user manual carefully and follow the safety instructions.

Note that there may be sections in this document, which are not relevant to your product, since this document applies to all available models (on the date of printing). If not otherwise stated, each section in this document refers to all models of the product.

The models and configurations available in your country can be found in the country-specific sales documents.

Invacare reserves the right to alter product specifications without further notice.

Before reading this document, make sure you have the latest version. You find the latest version as a PDF on the Invacare website.

If you find that the font size in the printed document is difficult to read, you can download the PDF version from the website. The PDF can then be scaled on screen to a font size that is more comfortable for you.

For more information about the product, for example product safety notices and product recalls, contact your Invacare distributor. See addresses at the end of this document.

In case of a serious incident with the product, you should inform the manufacturer and the competent authority in your country.

1.2 Symbols in this document

Symbols and signal words are used in this document and apply to hazards or unsafe practices which could result in personal injury or property damage. See the information below for definitions of the signal words.



WARNING

Indicates a hazardous situation that could result in serious injury or death if it is not avoided.



CAUTION

Indicates a hazardous situation that could result in minor or slight injury if it is not avoided.



IMPORTANT

Indicates a hazardous situation that could result in damage to property if it is not avoided.



Tips and Recommendations

Gives useful tips, recommendations and information for efficient, trouble-free use.

1.3 Compliance

Quality is fundamental to the company's operation, working within the disciplines of ISO 13485.

This product features the CE mark, in compliance with the Medical Device Regulation 2017/745 Class I. The launch date of this product is stated in the CE declaration of conformity.

We are continuously working towards ensuring that the company's impact on the environment, locally and globally, is reduced to a minimum.

We only use REACH compliant materials and components.

1.4 Service Life

The expected service life of this product is five years when used in accordance with the safety instructions, maintenance intervals and correct use, stated in this manual. The effective product life cycle can vary according to frequency and intensity of use.

1.5 Warranty Information

We provide a manufacturer's warranty for the product in accordance with our General Terms and Conditions of Business in the respective countries.

Warranty claims can only be made through the provider from whom the product was obtained.

1.6 Limitation of Liability

Invacare accepts no liability for damage arising from:

- Non-compliance with the user manual
- Incorrect use
- Natural wear and tear
- Incorrect assembly or set-up by the purchaser or a third party
- Technical modifications
- Unauthorised modifications and/or use of unsuitable spare parts

2 Safety

2.1 General Safety Information

**WARNING!****Risk of Serious Injury or Damage**

Improper use of this product may cause injury or damage.

- If you are unable to understand the warnings, cautions or instructions, contact a health care professional or provider before attempting to use this equipment.
- Do not use this product or any available optional equipment without first completely reading and understanding these instructions and any additional instructional material such as user manual, service manual or instruction sheet supplied with this product or optional equipment.

**WARNING!****Risk of Serious Injury**

- Incorrect use can lead to hazardous situations.
- Do not use on stairs or on escalators.
 - Do not stand on the product.
 - Be careful when walking on sloping or slippery ground or on uneven surfaces.
 - Do not use the product to transport a person.
 - Avoid walking against obstacles, both forwards and backwards.
 - Make sure that no clothes, such as long skirts, can get stuck in the wheels.
 - Do not let children play with the product.

**CAUTION!****Risk of Injury**

Unbalanced or heavy load may lead to overturning.

- Do not hang any loads, such as bags, to the frame, the push handles or **hand knobs**.
- Only carry loads with the designated equipment, like basket or tray. Do not exceed the maximum load for the equipment.
- The total load, including the weight of the user and any additional load, must not exceed the maximum user weight.
- Refer to chapter 7 *Technical Data*, page 18 for maximum user weight and load information.



CAUTION!

Risk of Injury

Non-original or wrong parts may affect the function and safety of the product.

- Only use original parts for the product in use.
- Due to regional differences, refer to your local Invacare catalog or website for available options or contact your Invacare distributor. See addresses at the end of this document.



CAUTION!

Risk of First Degree Burns

Parts of the product may heat up, when exposed to high temperatures (above 41° C).

- Be careful if the product is exposed to high temperatures, e.g. direct sunlight.



IMPORTANT!

There is a risk of damage **due to wear, e.g. corrosion.**

- Do not use the product under water, e.g. in pools.
- Do not use the product in hot areas like saunas.
- Do not store the product in wet or humid environments.



2.2 Labels and Symbols on the Product

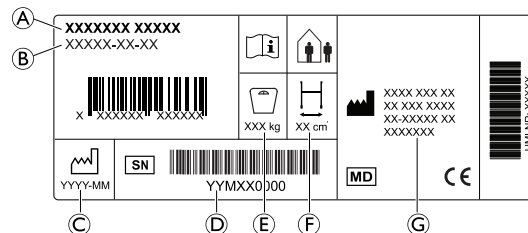

Identification label



- Ⓐ Product name
- Ⓑ Part number
- Ⓒ Date of manufacture
- Ⓓ Serial number
- Ⓔ Maximum user weight
- Ⓕ Maximum width
- Ⓖ Manufacturer address

Symbols

	European Conformity		Medical Device
	Manufacturer		Read user manual
	Date of manufacture		Serial number

	Maximum width		Maximum user weight
	Indoor / Outdoor use		

3 Product Overview

3.1 Product Description

The rollator is a four-wheeled walking aid with a central seat that can be folded up for storage and transportation. Front castors are steering castors. Rear castors are provided with a brake system for slowing down and for locking the castors. The rollator is available in different sizes and can be equipped with a wide range of accessories.

3.2 Intended Use

The walking aid is intended to support during walking and may also serve as a resting seat.

The walking aid is suitable for indoor and outdoor use on even ground.

The intended user is an adult with a maximum user weight as stated on the product label and in chapter 7 *Technical Data*, page 18.

3.3 Indications for Use

Indications

Persons with impaired muscle strength and/or balance, who need additional support whilst walking. The remaining walking and cognitive ability must be sufficient for safe use of a walking aid.

Contraindications

Persons with severe equilibrium disorders or functional perceptual disorders.

1637696-B

3.4 Main Parts

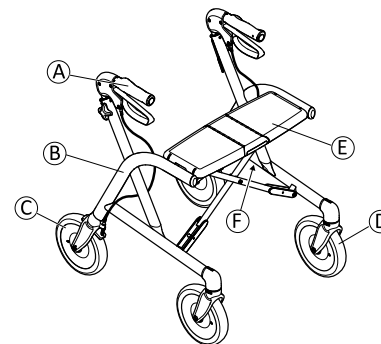

- Ⓐ Push handles with hand brakes
- Ⓑ Frame
- Ⓒ Rear castors with brake system
- Ⓓ Front castors
- Ⓔ Seat
- Ⓕ Location of the identification label

The product is delivered fully assembled.

3.5 Accessories

Various accessories, like baskets, are available for this product. The accessories available in your country can be found in the country-specific sales documents. Contact your Invacare provider.

4 Usage

4.1 Before Use



CAUTION!

Risk of Injury or Damage to Property

- Before use, ensure that the hand knob for the height adjustment is securely tightened.
- Before use, check the product for any defect.
- Do not use a defective product.

Invacare presume a healthcare professional has made an individual assessment of the user to determine his risk level or therapy requirements. Providers and carers have assessed that the product gives the required support and that its adjustments are appropriate for the user. Carer and user have been appropriately trained by a healthcare professional on how to use the product correctly and safely.

4.2 Adjusting the handle height



WARNING!

Risk of falling

- Always ensure that the hand knobs are tightened securely to prevent the handle from unintended lowering.
- Do not set the handles above their highest allowed position, indicated by the marking on the tubes.



If the user is not supposed to adjust the height of the handles, e.g. for safety reasons, the hand knobs can be replaced by locking screws (available as accessory).

For upright walking, the handles should usually be positioned at wrist height (when standing behind the walking aid with flat shoulders). Therapist may suggest different heights depending on specific needs of the user.

To provide a more comfortable hand position, the handles can be swivelled to point inwards. A locking mechanism prevents exceeding the maximum allowed angle.

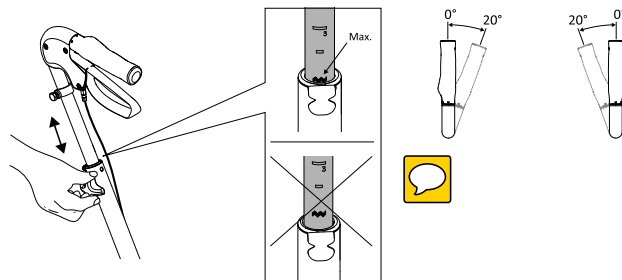

1. Stand behind the walking aid with flat shoulders.
2. Loosen the hand knob.
3. Adjust the handle to suitable height.
4. If necessary, swivel the handle to point inwards.
5. Retighten the knob. Press on the handle to check for secure fit.
6. Repeat the procedure on the other side. Ensure that both handles have the same adjustment.

4.3 Unfolding to operating position



WARNING!

- Always make sure that the rollator is fully unfolded and the lock is engaged before using the rollator.

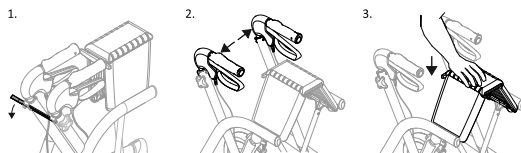

1. Release the fixation strap, if attached.
2. Pull the push handles outwards.
3. Press on the seat until the rollator is fully unfolded.
When in operating position, the release handle of the seat will “click” into a locked position.

4.4 Folding for Storage or Transport



CAUTION!

Risk of injury or damage

- When lifting the unfolded rollator at the seat, it can accidentally fold and cause injury.
- Always lift the rollator at the frame and the push handles.
 - Do not touch the release handle when lifting the unfolded rollator.



CAUTION!

Risk of pinching

- Be careful when folding the rollator.

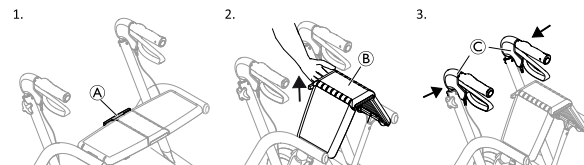

1. Stand next to the rollator and pull the release handle (A) outwards.
2. Lift the seat (B) upwards.
3. Press the push handles (C) inwards to fold the rollator.

For storage and transport, the rollator can be fixed in folded position:

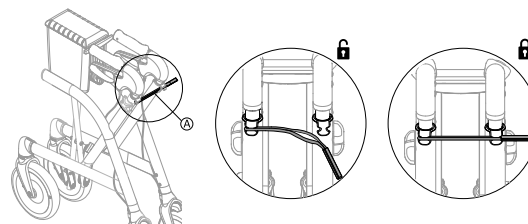

1. Attach the fixation strap (A) to both knobs.

4.5 Walking



WARNING!

Risk of falling

- Be careful if the wheels stop against an obstacle, e.g. a kerb.

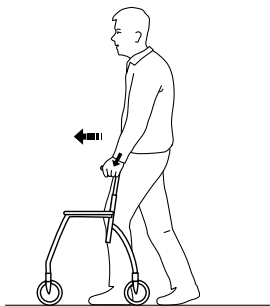

1. Place the walking aid slightly in front of you and take a step towards it while using the hand grips for support.

4.6 Sitting Down on a Chair

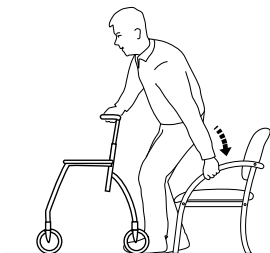

1. Stand in front of the chair with the walking aid, the back of your legs should touch the chair.
2. Lock both hand brakes of the walking aid.
3. Place your hands on the arms of the chair, lean forward slightly and sit down carefully.

4.7 Rising to a Standing Position



WARNING!

Risk of tipping

- Do not use the walking aid to pull yourself up from a sitting position.

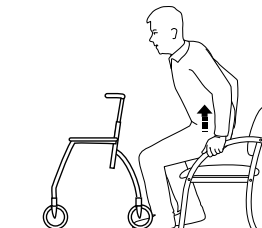

1. Place the walking aid in front of you and lock both hand brakes.
2. Use the armrests of the chair as support and rise carefully to a standing position.
3. Once stable in a standing position, transfer hands to the hand grips of the walking aid.

4.8 Sitting on the Walking Aid



WARNING!

Risk of Falling

- Use the walking aid for stationary seating only.
- Before sitting down, lock both brakes in parking position and make sure the walking aid stands stable.
- Always sit on the walking aid from the rear side. Do not sit down from the front side.
- Do not sit on the walking aid on sloping ground.
- Do not maneuver the walking aid with your feet while sitting on it.

4.9 Using the Hand Brakes

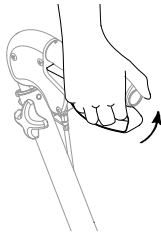

1. To slow down, pull both brake handles upwards.
2. To move again, carefully let go both brake handles.

Locking the Hand Brakes in Parking Position



1. To lock the hand brakes, press both brake handles downwards.
An audible click indicates that the brake is in locked position.
2. To unlock and release the hand brakes, pull both brake handles upwards.

Adjusting the Braking Effect



WARNING!

Risk of Injury

- If the braking effect is too low, the rollator can move, even if hand brakes are locked in parking position.
- Check the braking effect by applying the brake and verify that the wheel cannot rotate.

- If the locking nut is not tightened, it could loosen and the hand brakes won't work anymore.
- After each adjustment, make sure that the locking nut is tightened properly.

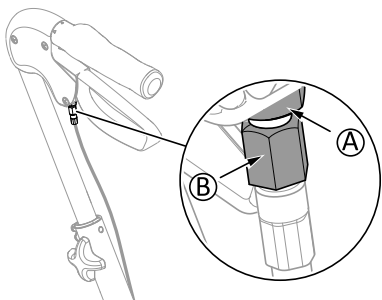

8 + 10 mm spanner (not included)

The brake handle must be in unlocked position to adjust the braking effect.

1. Loosen the locking nut **A**.
2. To decrease the braking effect, turn the adjusting nut **B** clockwise.
To increase the braking effect, turn the adjusting nut **B** counter clockwise.
(The distance between the brake clamp and the wheel should be 2 mm.)
3. Tighten the locking nut **A** properly to fix the new adjustment.

5 Maintenance

5.1 General Maintenance Information



WARNING!
Risk of Injury

- Maintenance should be done at least once a year.
- Do not use a defective product.
- Do not attempt repairs yourself. For repairs contact your provider.

5.2 Inspection checklist

To ensure good performance and safety, inspect your product regularly.

- Ensure that all screws and adjustments are properly tightened.
- Ensure that hand grips are tight.
If hand grips are loose do not use the walking aid. Instructions on how to change hand grips can be obtained from your provider or Invacare distributor.
- Verify brake operation. If brake adjustment is required, see chapter 4 *Usage, page 10*.
- Inspect the frame and loaded parts for cracks.
- Inspect the castors' tightness, wear and damage.
- Make sure that the castors are free of hair, lint and other debris.

5.3 Cleaning and Disinfection

5.3.1 General safety information



CAUTION!

Risk of contamination

- Take precautions for yourself and use appropriate protective equipment.



IMPORTANT!

Wrong fluids or methods can harm or damage the product.

- All cleaning agents and disinfectants used must be effective, compatible with one another and must protect the materials they are used to clean.
- Never use corrosive fluids (alkalines, acid etc.) or abrasive cleaning agents. We recommend an ordinary household cleaning agent such as dishwashing liquid, if not specified otherwise in the cleaning instructions.
- Never use a solvent (cellulose thinner, acetone etc.) that changes the structure of the plastic or dissolves the attached labels.
- Always make sure that the product is completely dried before taking it into use again.



For cleaning and disinfection in clinical or long-term care environments, follow your in-house procedures.

5.3.2 Cleaning Intervals

**IMPORTANT!**

Regular cleaning and disinfection enhances smooth operation, increases the service life and prevents contamination.

Clean and disinfect the product

- regularly while it is in use,
- before and after any service procedure,
- when it has been in contact with any body fluids,
- before using it for a new user.

5.3.3 Cleaning Instructions

The product can be washed in a washing machine or by hand.

When using a high-pressure cleaner or an ordinary jet of water, do not aim the jet towards bearings, draining holes or labels.

The maximum cleaning temperature is 60 °C. Do not use a steam cleaner.

1. Clean the walking aid with a damp cloth and mild detergent.
2. Clean the castors with a brush (no wire brush).
3. After washing, wipe the product dry.

Disinfection

- Wipe down all generally accessible surfaces with disinfectant.

6 After Use

6.1 Disposal

Be environmentally responsible and recycle this product through your recycling facility at its end of life.

Disassemble the product and its components, so the different materials can be separated and recycled individually.

The disposal and recycling of used products and packaging must comply with the laws and regulations for waste handling in each country. Contact your local waste management company for information.

6.2 Reconditioning

This product is suitable for reuse. To recondition the product for a new user, carry out the following actions:

- Inspection
- Cleaning and disinfection

For detailed information, see *5 Maintenance, page 15* and the service manual for this product.

Make sure that the user manual is handed over with the product.

If any damage or malfunction is detected, do not reuse the product.

7 Technical Data

7.1 Dimensions and Weights

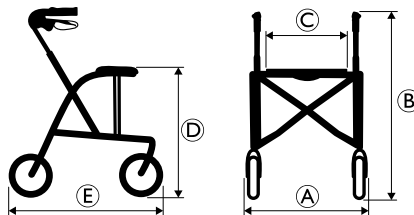

[mm]	Gloss 450	Gloss 520	Gloss 600	Gloss 680
Total width ①	518	595	602	609
Total height ②	635 – 770	725 – 860	795 – 920	915 – 1050
Seat width ③	370	445	445	445
Seat height ④	450	520	600	680
Total length ⑤	615	675	720	790
Width when folded	240	190	190	190
Front/ rear castor diameter	200			
Front/ rear castor width	40			

All dimensions are subject to certain tolerances.

[kg]	Gloss 450	Gloss 520	Gloss 600	Gloss 680
Weight ¹	5.9	6.3	6.5	6.8
Max. user weight ²	160			

Max. load basket	7.0
Max. load tray	5.0

¹ Total weight excluding equipment

² Weight limitation including weight of the user (whether standing or sitting) and any additional load (e.g. content of the basket)

7.2 Material

Frame	Polyester powder-coated aluminium
Handle bars	Anodised aluminium
Hand grips	TPE
Wheels	Polypropylene with treads of TPE
Plastic parts	Material according to marking (PA, PP)
Screws	Steel, rust protected



Invacare Distributors

Danmark:

Invacare A/S
Sdr. Ringvej 37
DK-2605 Brøndby
Tel: (45) (0)36 90 00 00
Fax: (45) (0)36 90 00 01
denmark@invacare.com
www.invacare.dk

Norge:

Invacare AS
Grensesvingen 9, Postboks 6230,
Etterstad
N-0603 Oslo
Tel: (47) (0)22 57 95 00
Fax: (47) (0)22 57 95 01
norway@invacare.com
www.invacare.no

Sverige:

Invacare AB
Fagerstagatan 9
S-163 53 Spånga
Tel: (46) (0)8 761 70 90
Fax: (46) (0)8 761 81 08
sweden@invacare.com
www.invacare.se

Suomi:

Camp Mobility
Patamäenkatu 5, 33900 Tampere
Puhelin 09-35076310
info@campmobility.fi
www.campmobility.fi



Invacare Rea AB
Växjövägen 303
SE-343 71 Diö
Sweden

1637696-B 2019-10-08



Making Life's Experiences Possible®

Dolomite



Yes, you can.®