

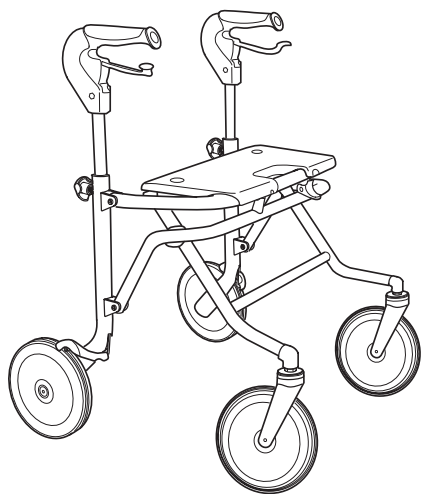

DOLomite *MELODY, SOPRANO*

Do not use the rollator as a
wheelchair or for transporta-
tion of people.



DOLomite MELODY
Maximum user weight 135 kg

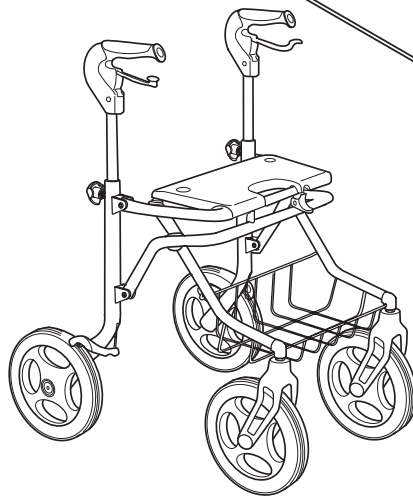

DOLomite SOPRANO
Maximum user weight 160 kg



OPERATING INSTRUCTIONS

Study the operating instructions carefully before use. The walker is suitable for use both indoors and outdoors.

SAFETY

- Not to be used for standing on or as a wheelchair.
- Never sit on the rollator and kick yourself forward by foot.
- Both brakes must be in the **parking position** when the rollator is used as a seat.
- The parking brakes must be in braked position when the rollator is used as a support when getting up, from a chair for example.
- The rollator must be fully unfolded and locked when used as a walking support.
- NB! Only to be used as a walking support.
- Exercise caution when walking on sloping ground.
- Do not go up or down stairs with the rollator.
- Do not use the rollator on escalators.
- Be extra careful when carrying heavy loads in the basket. The maximum load in the basket is:
7 kg for **DOLOMITE MELODY S**,
10 kg **DOLOMITE MELODY M, L** and
12 kg for **DOLOMITE SOPRANO**.
Loads may only be carried in the basket or on the tray (**DOLOMITE SOPRANO**).
- NB! Check that there is no pressure on the safety catch from load in basket or tray.

OPERATING POSITION

When unpacking or unfolding from transport position lift front frame according to fig. C.

1. Unfold the walker by pressing down on the seating tube. Check that the safety catch is in the locked position when the walker is completely unfolded.
2. The seat can be folded up to provide a larger walking space, and in order to increase accessibility.

FOLDING

If basket is used, it must be dismantled before folding the walker.

1. Press down the safety catch.
2. Pull the seating tube upwards.
3. The walker can be folded into two different positions.
 - A The walker is to be folded to the first position if it is to be parked when folded.
 - B It is recommended that the walker is folded to a further stage, the inner position, if it is to be transported when folded. Note that the walker cannot stand upright when in this position.
 - C Unfolding from transport position.

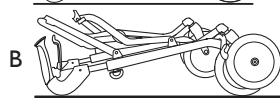
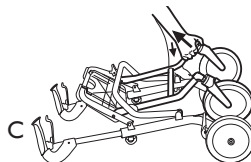
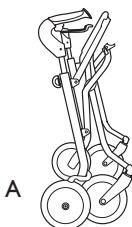
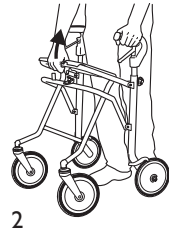
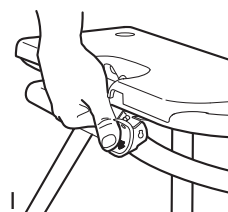
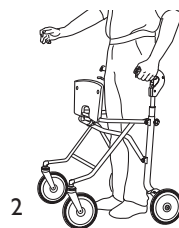
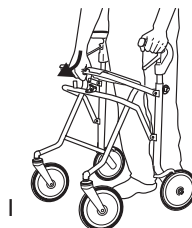

BRAKE

Apply the brakes by pulling both brake handles upwards.

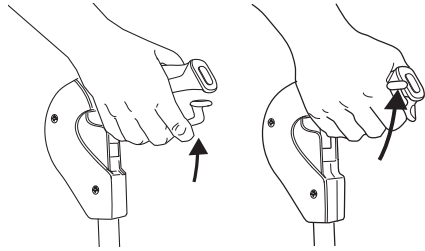

PARKING BRAKE

1. Press the brake handles carefully downwards to apply the parking brakes. A clear sound is heard when the brakes are applied correctly. It is important that both parking-brakes are applied.
2. Release the parking brakes by pulling the handles upwards.
For users who feel that the walker rolls too quickly and who therefore make frequent use of the brake, we recommend a walker with a slow-down brake (accessory).

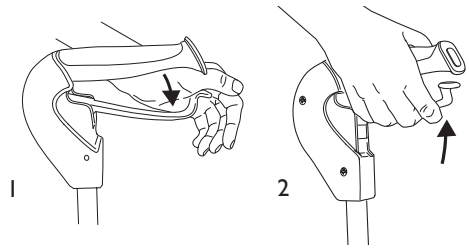

ASSEMBLING THE TRAY AND THE BASKET

A **DOLOMITE MELODY**
B **DOLOMITE SOPRANO**

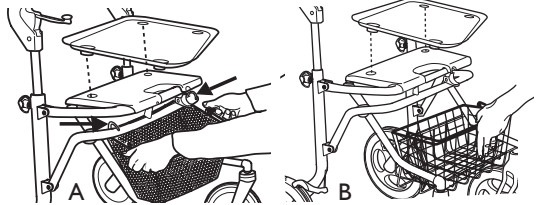

ADJUSTING THE HANDLEBARS

NB! The brake must not be in the on position when adjusting the handle.

1. Loosen the height adjustment knobs, but do not remove them completely.
2. Adjust the handlebars to the correct height. The handlebars should normally be placed at the height of the user's wrists.
3. The handles can be adjusted such that they point inwards in order to provide a more comfortable hand position. This may also be required if the user has limited wrist mobility.
4. Tighten the height adjustment knobs.

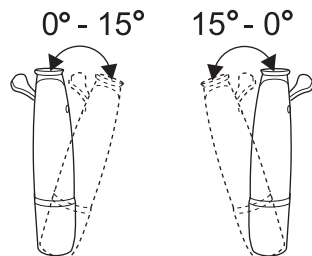
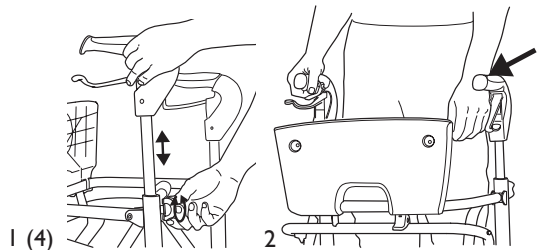

If there is a risk of the user removing the height adjustment knobs, these should be replaced by locking screws (available as an accessory).

ADJUSTING THE BRAKE EFFECT

Allen key number 3 (not supplied) can be used to increase the braking effect. The distance between the brake head and the wheel should be 0,5 mm.

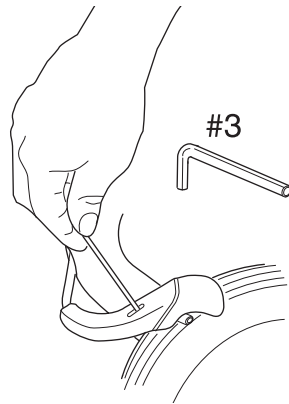

CARE OF THE WALKER

In order to maintain good performance and safety, you should regularly ensure that the following measures are carried out:

- Clean the walker with a solvent-free household cleaner. Dry thoroughly. Keep the wheels clean.
- Check that screws and adjustments are properly tightened.
- Immediately contact your prescriber if the walker develops a fault. Never use a defective walker.

DOLOMITE will not accept responsibility for adaptations, faulty repairs, etc., that lie outside of the company's control. The user's maximum weight for **DOLOMITE MELODY** is 135 kg, and for **DOLOMITE SOPRANO** 160 kg.

INSTRUCTIONS FOR DESTRUCTION OF PRODUCT AND PACKAGING:

When the product can no longer be used, it and its accessories, together with packaging material, should be sorted properly. The individual parts can be separated and handled according to the material's description.

The label on the **DOLOMITE MELODY** and **SOPRANO** provides all important technical information.

- 1: Article number
- 2: Product name
- 3: Serial number
- 4: Date of manufacture
- 5: Max. user weight
- 6: NB! See user manual.
- 7: In- and outdoor rollerator.
- 8: Max. width of rollerator.
- 9: Manufacturer's name.

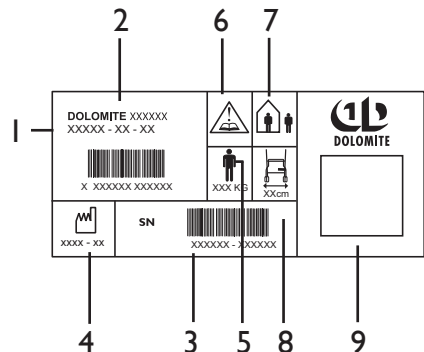

Manufacture:
 INVACARE DOLOMITE AB, Box 200, 343 75 DIÖ, SWEDEN
 TEL +46 (0)476 535 00, FAX +46(0)476 535 99

Sales companies:
 Invacare Ltd, Pencoed Technology Park, Pencoed, Bridgend CF35 5HZ
 TEL (44) (0)1656 776 200, FAX (44) (0)1656 776 201
 UK@invacare.com, eire@invacare.com